

PV-B1412

PV-B1412 Fishing Pontoon Prairie View

1	62340	Literature Bag - Trailers
2	4300144	4.80X12-B Tire/White Mod Rim
1	6606701	Frame Bundle - Pontoon Fishing
1	6606601	Hardware Box - Pontoon Fishing
1	6578001	3X3X14 GA. X 7' Tongue

Tire Size & Carrying Capacity Chart

Tire Size	Load Range	Carrying Capacity
4.80X12	B	780 lbs.

Refer to tire side wall for correct tire pressure.

Tongue Weight Adjustment

Slide the water vehicle either forward or backward on the trailer until the proper tongue weight has been achieved.

Final Assembly Instructions

Springs

Mount the 4-leaf slipper springs to the axle using two (2) 3/8" X 2-3/16" X 2" square u-bolts per side on axle from the top down and secure with 3/8" flange lock nuts.

Axle

Place one (1) of the spring bushings into the rear of the spring bracket and secure with a 1/2" X 3" hex bolt and a 1/2" flange lock nut. Repeat on other side. Position the axle under the frame, slide the slipper spring above the bushing then raise the axle assembly up so that the front of the springs line up with the front spring bracket hole. Insert the 9/16" X 3-1/4" hex bolt and secure with a 9/16" hex lock nut. Repeat on other side of axle. Tighten all fasteners. Do not overtighten. The spring must have room enough to move.

Mount the tire and rim assemblies using 80-90 ft./lbs. of torque on lug nuts using a proper tightening procedure.

Tongue

Insert the tongue into the tongue channel on the frame and slide into the front cross member channel. Place a 3/8" X 4" carriage bolt from the top down into the front cross member and tongue. Secure with a 3/8" flange lock nut. Insert a 3/8" X 4" carriage bolt from the side of tongue channel cap on the frame and into the tongue. Secure with a 3/8" flange lock nut.

Side Marker Light

Locate the side marker light holes on the side of the tongue. Mount the amber side marker light into the tongue using two (2) #10 X 3/4" self drill screws. Repeat on other side of the tongue.

Safety Chain

Insert a 3/8" X 1-1/4" hex bolt through a 3/8" flat washer and safety chain. Then insert this assembly into the lower hole on tongue and secure with a 3/8" flat washer and 3/8" flange lock nut on the inside of the tongue. Repeat on opposite side of the tongue.

Coupler

Mount the coupler to the top holes on the tongue using a 1/2" X 4" hex bolt in the rear hole and using two (2) 1/2" X 1" hex bolts in the front holes. Secure with 1/2" flange lock nuts. **NOTE: The ground wire will be secured to the 1/2" X 4" hex bolt for grounding purposes.**

Tongue Stand

Mount the tongue stand to the front under side of the tongue by inserting the key lock into the key hole. Turn to align and secure with 1/2" X 1" hex bolt. Tighten with a 1/2" flange lock on the inside of the tongue.

Winch

Mount the winch stand to the tongue in a desired location that best fits your boat. Secure with three (3) 3/8" X 4" hex bolts and 3/8" flange lock nuts.

Mount the winch handle on the winch using the hardware provided with the winch.

Bunk

Mount the saddle brackets to the frame using 3/8" X 1-15/16" X 4" square u-bolts from the bottom of frame and up through the saddle bracket. Secure with 3/8" flat washers, 3/8" lock washers and 3/8" hex finish nuts. Refer to parts drawing on page 3 for placements.

Mount the bunk to the saddle brackets on the frame using 1/4" X 1-1/2" HH lag screws leaving about 4" of bunk out the back. (Measure from the tail light bracket back.)

Material List for the PV-B1412

NOTE: ShoreLand'r offers their product line in either galvanized or painted finish. When ordering parts it is important that you specify the finish or color you have on your product. The five digit number along with a two digit space ___, notes the parts which can be purchased with various finishes. When ordering these items use the five digit prefix and include the following two digit suffix for proper finish.

Suffix	Finish / Color
00 or G	Galvanized
01	Arctic White
03 or BK	Black

REF#	PART#	DESCRIPTION	QTY	REF#	PART#	DESCRIPTION	QTY
1	65780--	3X3X14GA X 7' TONGUE	1	38	0110037	3/8" X 1-1/4" HEX BOLT	2
2	4300144	4.80X12-B TIRE/WHITE MOD RIM	2	39	5110427	AMBR SIDEMARK LITE-66" PIGTAIL	2
3	62780--	SPRING BRACKET - BOLT-ON	2	40	0810925	#10-16 X 3/4" SELFDRIILL SCREW ...	4
4	65462--	FRAME WELDMENT - FISH 56"	1	41	64435--	56" AXLE WELDMENT	1
5	5110481	FRAME HARNESS - FISH 56"	1	42	0110060	3/8" X 4" HEX BOLT	3
6	3510030	7/8" MOLDED GROMMET	6	43	8110241	WINCH HANDLE	1
7	0120052	3/8" X 2-3/4" HEX BOLT	4	44	4470337	1-1/16" X 1-1/16" CAST HUB	2
8	1340095	3/8" USS FLAT WASHER	17	45	4440160	1-1/16" ROLLER BEARING	4
9	1440101	3/8" FLANGE LOCK NUT	26	46	4410275	SEAL	2
10	1440102	1/2" FLANGE LOCK NUT	7	47	4410244	PLASTIC BEARING PROTECTOR	2
11	3510123	POLY FENDER - FISHING-WHITE	2	48	4410087	1-1/16" SPINDLE SLEEVE	2
12	S-3390	STEP PAD - RIGHT - WHITE	1	49	1540038	1/8" X 1-1/2" COTTER KEY	2
13	S-3391	STEP PAD - LEFT - WHITE	1	50	1440349	3/4" SLOTTED HEX NUT	2
14	0810126	1/4" X 1/2" SELF TAP SCREW	4	51	1340206	1-1/2" X .765 ID X .182-.206 WASH...	2
15	5110348	LICENSE PLATE BRACKET	1	52	0110170	9/16" X 3-1/4" HEX BOLT	2
16	5110378	TAILLIGHT - WATERPROOF - LEFT	1	53	1440259	9/16" HEX LOCK NUT	2
17	5110377	TAILLIGHT - WATERPROOF - RT	1	54	0110107	1/2" X 3" HEX BOLT	2
18	5110100	METAL FRAME CLIP	2	55	S-2029	SPRING BUSHING SPACER	2
19	0210133	3/8" X 4" CARRIAGE BOLT	4	56	S-2219G	BOLT-ON TONGUE STAND	1
20	66084	8' BUNK ASSY FOR PONT FISH	2	57	1340030	3/8" S/T MED LOCK WASHER	8
21	65526--	REAR CROSSMEMBER WLDMT	1	58	1410109	3/8" HEX FINISH NUT	8
22	S-3443	WINCHSTAND CHANNEL - 23"	1	59	0140040	3/8" X 1" HEX BOLT	3
23	66064--	BUNK SADDLE SUPPORT	4	60	0210102	3/8" X 1" CARRIAGE BOLT	2
24	0310102	3/8" X 1-15/16" X 4" SUB	4	61	1410230	1/2" HEX LUG NUT	10
25	3110338	WINCH DL600A W/16' STRAP/HOOK1		62	0810945	1/4" X 3/4" SELF DRILL SCREW	1
26	0110114	1/2" X 4" HEX BOLT	2				
27	6418300	BOW STOP BRACKET - GALV	1				
28	6418400	BOW ROLLER HOLDER BRKT	1				
29	3510055	BOW STOP - JB	1				
30	6240610	FENDER SUPPORT BRACKET	4				
31	0310292	3/8" X 2-3/16" X 2" SUB	4				
32	4610010	4-LEAF SLIPPER SPRING	2				
33	3310010	#980 P2 COUPLER	1				
34	0140090	1/2" X 1" HEX BOLT	3				
35	0710052	1/4" X 1-1/2" HH LAG SCREW	8				
36	5110080	13'-10" TONGUE HARNESS	1				
37	2210142	3/16" X 20 LINK CHAIN	2				

DECALS:

--	4810500	SMALL SHORELAND'R DECAL	2
--	4811409	SMALL WAVE DECAL - LEFT	1
--	4811408	SMALL WAVE DECAL - RIGHT	1
--	4850360	NMMA CERTIFIED TRAILER DECAL	1
--	4810709	CAUT/WARN TRAILER DECAL	1

ASSEMBLIES AND/OR OPTIONS

--	64449--	AXLE ASSEMBLY	
--	66068--	WINCH ASSEMBLY - PONTOON FISH	

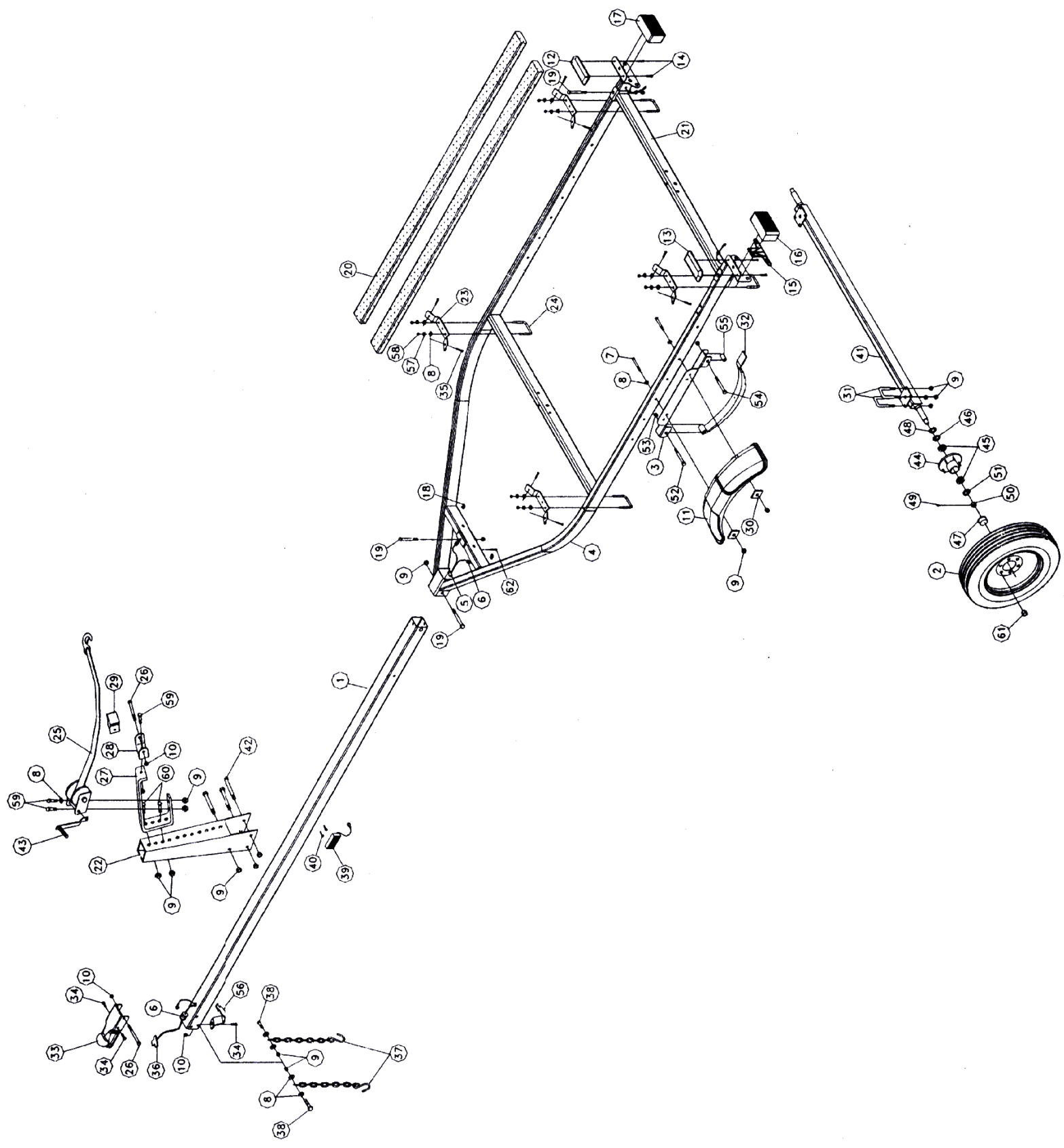

Assembly should be complete except for tightening some of the bolts. These bolts were left loose only to aid in adjusting the trailer to the boat. All bolts and nuts must be tightened before towing.

NOTE: The law requires that the white ground wire on both the tongue wire harness and vehicle harness must be properly grounded to respective trailer and vehicle frames.